

# Effective Thursday December 2nd at 2pm Runway 9R-27L reopens

**11,260' in length      150' wide**

Also opening on  
December 2nd will be the  
following taxiways:

G1 Taxiway High Speed.

G Taxiway full length

**Permanent Runway Frequency on December 2nd at 2pm will be 126.90**



# Specific Operational Conditions for Runway 9R-27L on Thursday December 2nd at 2pm

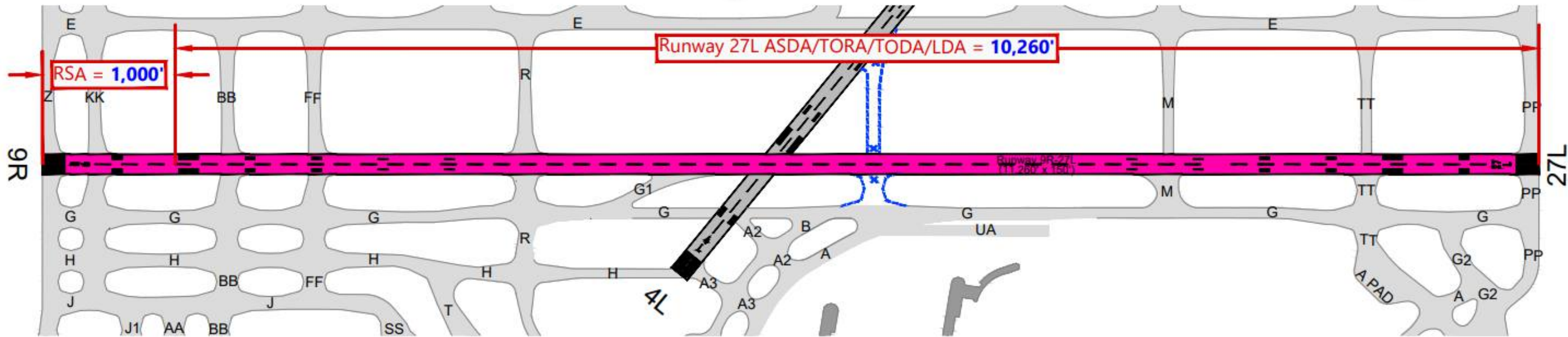

Due to required grading activities in the 9R ROFA west of the "Z" Taxiway, on December 2nd at 01400 hrs the following operational conditions will be in effect for 9R-27L:

1. To allow a full 1,000' RSA beyond the west end of the runway there will be a declared distances for runway 27L arrivals and departures of 10,260'
2. Runway 9R will be closed to arrivals by NOTAM (Full length departures available)
3. Declared distances and 9R arrival closure will be in effect until all grading is completed in the 9R RSA (spring 2022)

**Runway 27L Declared Distances: 10,260'**

Accelerate-Stop Distance Available (ASDA)  
Take-off Run Available (TORA)  
Take-off Distance Available (TODA)  
Landing Distance Available (LDA)



**Taxiway A1 remains closed upon opening of Runway 9R-27L until further advised**

**CLOSED**

**CLOSED**

